



# 6030-Z Deep groove ball bearings

## Deep groove ball bearings

### Bearing data

[Tolerances,](#)

Normal (metric), P6, P5, Normal (inch),

[Radial internal clearance,](#)

Matched bearing pairs, Stainless steel  
d < 10 mm, Other bearings

### Bearing interfaces

[Seat tolerances for standard conditions,](#)

[Tolerances and resultant fits](#)

## Technical specification

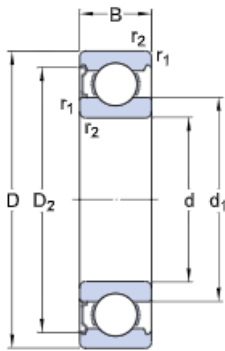

### DIMENSIONS

d	150 mm	Bore diameter
D	225 mm	Outside diameter
B	35 mm	Width
d <sub>1</sub>	≈ 174.15 mm	Shoulder diameter
D <sub>2</sub>	≈ 205.3 mm	Recess diameter
r <sub>1,2</sub>	min. 2.1 mm	Chamfer dimension

### ABUTMENT DIMENSIONS

d <sub>ε</sub> min.	160 mm	Diameter of shaft abutment
d <sub>ε</sub> max.	173.9 mm	Diameter of shaft abutment
D <sub>ε</sub> max.	215 mm	Diameter of housing abutment
r <sub>a</sub> max.	2 mm	Radius of shaft or housing fillet

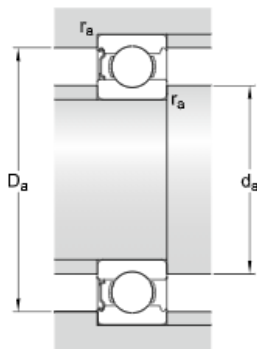

## CALCULATION DATA

C	125 kN	Basic dynamic load rating
C <sub>0</sub>	125 kN	Basic static load rating
P <sub>u</sub>	3.9 kN	Fatigue load limit
	6 000 r/min	Reference speed
	3 800 r/min	Limiting speed
k <sub>r</sub>	0.025	Minimum load factor
f <sub>0</sub>	15.9	Calculation factor

## MASS

	4.28 kg	Mass bearing
--	---------	--------------

## TOLERANCE CLASS

Normal	Dimensional tolerances
Normal	Radial run-out